

Plan Information

Tenure Type	Freehold
Plan Type	Deposited Plan
Plan Purpose	Subdivision

Plan Heading

Lots 55-58, 61-70, 73-94, 97-105, 8001, 9028, Roads and Restrictive Covenant

Locality & Local Government

Locality	Champion Lakes
Local Government	City of Armadale

Department of Planning, Lands and Heritage

File Number

Examination

Examined	Date
----------	------

Planning Approval

Planning Authority	Western Australian Planning Commission
Reference	163897

Delegated under S. 16 P&D Act 2005	Date
------------------------------------	------

In Order For Dealings

Subject To	
------------	--

For Inspector of Plans and Surveys	Date
------------------------------------	------

Plan Approved Reg. 26A (4)

Inspector of Plans and Surveys / Authorised Land Officer	Date
--	------

Survey Details

Field Records	148963
Declared as Special Survey Area	Yes

Survey Method Regulatory Statement

Survey carried out under Reg. 26A Special Survey Area Guidelines. See survey sheet(s) to determine the true final position and type of all survey marks placed for this plan.

Survey Method and Plan Content Variations

Approved Variation Type	Reference
-------------------------	-----------

Survey Certificate - Regulation 54

I, Nigel J. SIMPSON
 hereby certify that this plan is accurate and is a correct representation of the -
 (a) survey; and
 (b) calculations from measurements recorded in the field records,
 undertaken for the purposes of this plan and that it complies with the relevant
 written law(s) in relation to which it is lodged.

FINAL

Licensed Surveyor	Date
-------------------	------

Survey Organisation

Name	MNG MCMULLEN NOLAN GROUP
Address	PO Box 124, BULL CREEK W.A. 6149
Phone	6436 1599
Fax	6436 1500
Email	info@mngsurvey.com.au
Reference	102331dp-018c

Amendments

Version	Lodgement Type	Amendment Description	Authorised By	Date
---------	----------------	-----------------------	---------------	------

Former Tenure

New Lot / Land	Parent Plan Number	Parent Lot Number	Title Reference	Subject Land Description
55-58, 61-70, 73-94 97-105, 8001, 9028	DP 406044	Pt Lot 9027	4047/602	

New Interests

Subject	Purpose	Statutory Reference	Origin	Land Burdened	Benefit To	Comments
	RESTRICTIVE COVENANT	SEC 136D OF THE TLA 1893	THIS PLAN & DOC	ALL LOTS EXCEPT LOTS 8001 & 9028	ALL LOTS EXCEPT LOTS 8001 & 9028	

New Notifications and Memorials

Subject	Purpose	Statutory Reference	Origin	Land Burdened	Benefit To	Comments
	NOTIFICATION (Hazards or other Factors)	SEC 165 OF THE P & D ACT 2005	DOC	ALL LOTS EXCEPT LOTS 8001 & 9028		PROXIMITY TO MOSQUITO BREEDING AREA
	NOTIFICATION (Hazards or other Factors)	SEC 165 OF THE P & D ACT 2005	DOC	LOTS 55-57, 82-84		ROWING COURSE NOISE
	NOTIFICATION (Hazards or other Factors)	SEC 165 OF THE P & D ACT 2005	DOC	LOTS 55-58, 61-63, 79-88, 103-105		BUSHFIRE MANAGEMENT PLAN

Vesting Lots

Subject	Purpose	Statutory Reference	Origin	Land Burdened	Benefit To	Comments
LOT 8001	RESERVE FOR RECREATION	VESTS IN THE CROWN UNDER SEC 152 OF THE P & D ACT 2005	THIS PLAN			

LIMITED IN DEPTH TO 609.6 METRES

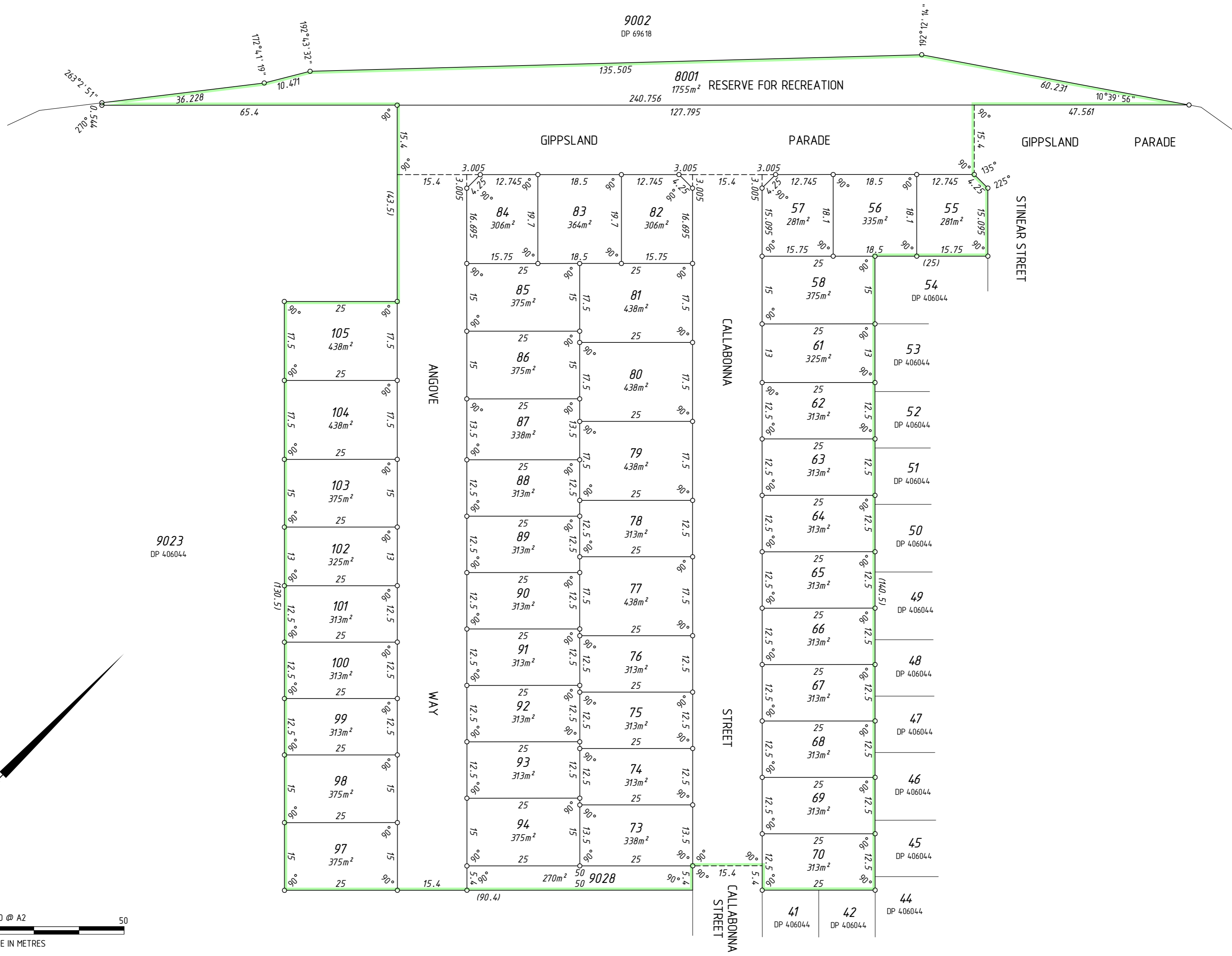

9023
DP 406044

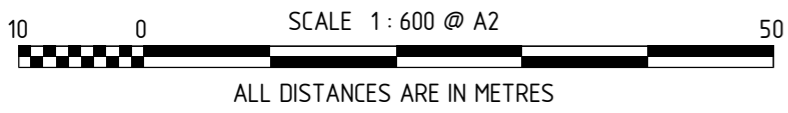

THIS SURVEY SHEET WILL BE
REPLACED BY THE SURVEY DATA



MC MULLEN NOLAN GROUP
PO Box 124, Bulli Creek W.A. 6149
Tel: (08) 6436 1599
Fax: (08) 6436 1500
Email: info@mngsurvey.com.au

MNG Ref : 102331dp-018c

VERSION NUMBER

1

DEPOSITED PLAN

428071